

DESCRIPTION

Laboratory sink for undermount installation, 10 mm (3/8 in) thick, black polypropylene, 38 mm (1½ in) rim, 38 mm (1½ in) integrated drain assembly situated center of bowl.



SINGLE BOWL MODEL



DUAL BOWL MODEL

Standards Models	A Length in mm		B Width in mm		C Length (I.D.) in mm		D Width (I.D.) in mm		E Depth in mm		Nbr of bowls
CA-EVIN1614510-UN	16	406	14½	368	13	330	11½	292	10	254	1
CA-EVIN202010-UN	20	508	20	508	17	432	17	432	10	254	1
CA-EVIN271911-UN	27	686	19	483	24	610	16	483	11	279	1
CA-EVIN3251910-UN	32	826	19	483	29	737	16	483	10	254	2

Meets standards:
CSA B455.11
IAPMO Z124 (2012)

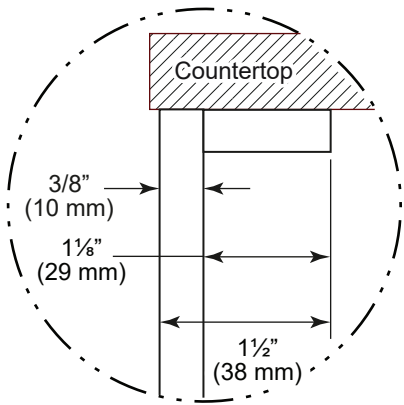

Notes: (I.D.) Interior dimensions. For countertop opening, deduct ½" from dimensions C and D.

SINGLE BOWL MODEL

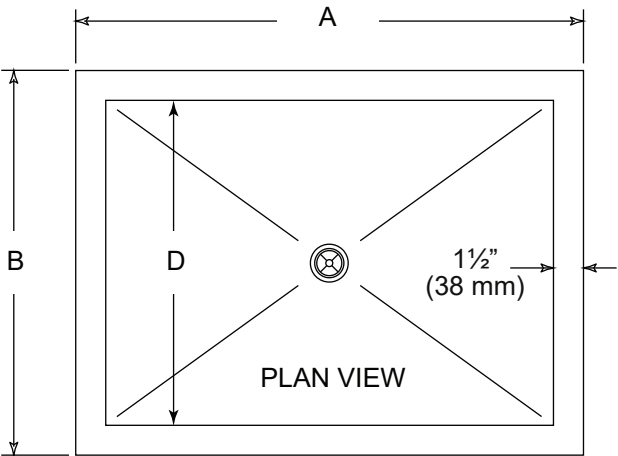

DUAL BOWL MODEL

